



**WAHL®**  
MODEL/TYPE 9906



[WWW.WAHL-CONSUMER.COM](http://WWW.WAHL-CONSUMER.COM)

**WAHL CLIPPER CORPORATION**  
World Headquarters  
P.O. Box 578, Sterling, IL 61081

Wahl (UK) Ltd.  
Heme Bay Trade Park  
Sea Street Heme Bay, Kent  
CT6 8JZ England

Wahl International Consumer Group B.V.  
Engelenburgstraat 36  
7391 AM Twello, The Netherlands

Wahl Australia PTY LTD  
3 Durbell St, PO Box 456  
Acacia Ridge QLD 4110  
Australia

Wahl Argentina  
Av. Alvarez Jonte 5655  
Buenos Aires (C1407GPK) Argentina

Wahl Clipper (PTY) Ltd.  
Suite L9 & L10  
Hingham Field Office Park  
79 Boeing Road East  
Bedfordview, Gauteng 2007  
South Africa

Wahl NZ Limited  
4 Cornish St., Korokoro  
Lower Hutt 5045, N.Z.

Wahl International  
Consumer Group B.V.  
(Dubai Branch)  
Dubai Silicon Oasis  
P.O. Box - 341023  
Dubai  
United Arab Emirates

WAHL Russia  
(ООО «Волж Рус») Российская Федерация  
129164, Москва,  
Ракетный бульвар, 16  
info@wahlrus.ru

Wahl India Grooming Products Pvt Ltd  
201, 2nd Floor 'X' Cube,  
Opp. Fun Republic  
New Link Road, Andheri (West)  
Mumbai - 400 053 Maharashtra, India

Wahl Clipper Brasil  
Rodovia Geraldo Scavone, 2300  
UC 45, Pedregulho,  
Jacarei - SP, CEP: 12305-490

WAHL Spain  
Fernando Giner de los Rios 12  
46910 Sedavi  
Valencia, Spain



© 2017 Printed in China  
Wahl® is a registered trademark  
of Wahl Clipper Corporation

Part No. 1000848



1.



2.



3.



4.

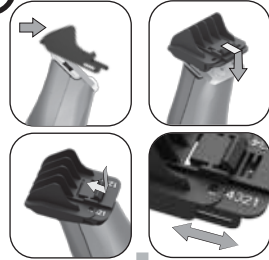
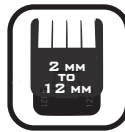
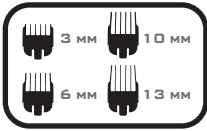
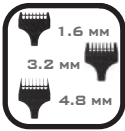

1.



2.



3.

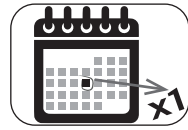

1.



2.

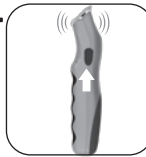

3.



4.



5.

